

© Ordnance Survey Ireland.
All rights reserved. Licence
number 2010/20 CCMA/ Sligo
County Council

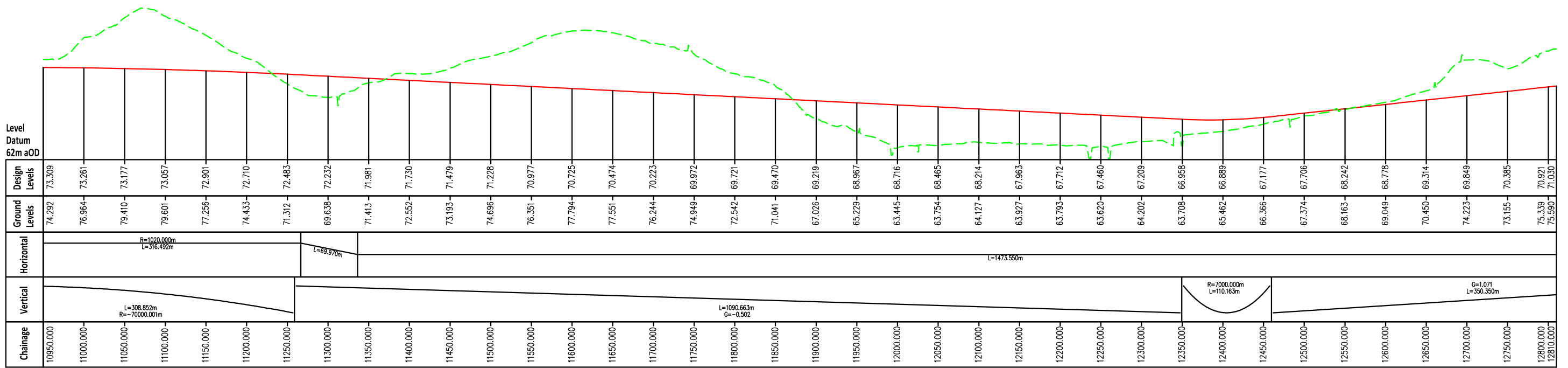
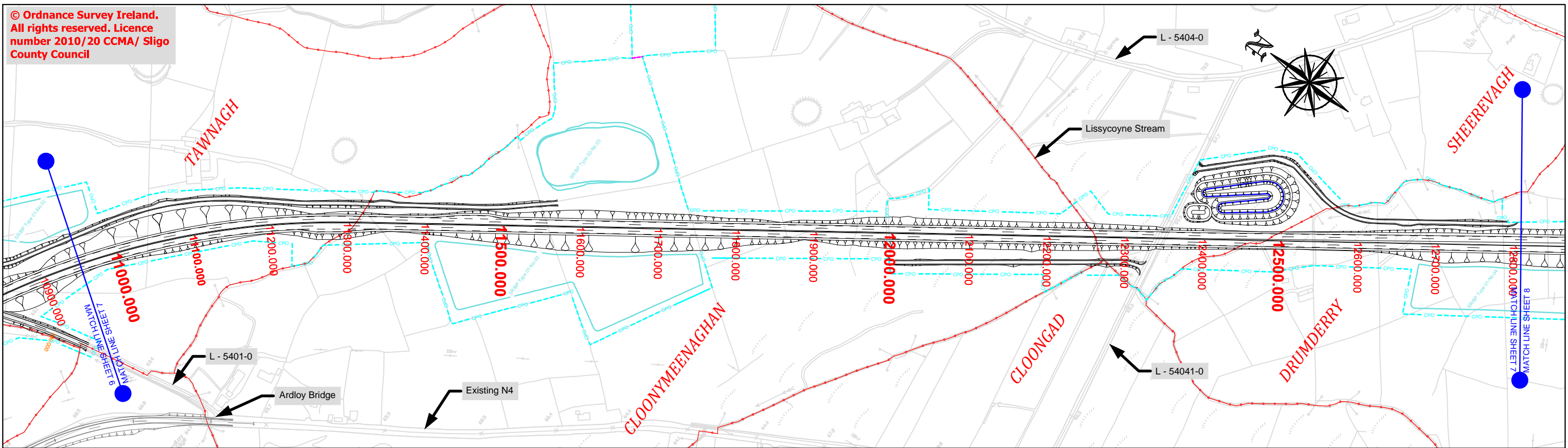

Legend

Geometrics Details

- Proposed Design Level
- Existing Ground Level
- Townland Boundary
- CPO Boundary
- Land Made Available (LMA)
- Retaining Wall
- LACKAGH 8,300.000
- Townland Names
- Design Chainage
- Constructed Wetland
- Existing Attenuation Pond
- Spoil Repository
- Landscape Mitigation Site

NOTE:
No other use of this material may be made without the licence of the copyright holder in accordance with Section 74(3) of the Copyright and related Rights Act, 2000.

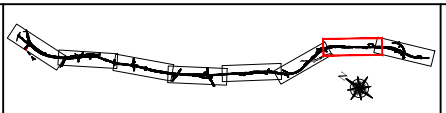

NOTE:
All proposed road levels indicated are based on a Design prepared for Phase 3 and 4 of the NRA PMG and may be revised at the Detailed Design Stage.
Modifications may be made to avail of opportunities to improve the design in the light of experience on the ground or other innovations provided this has no significant adverse environmental effects.



National Road Design Department
Sligo County Council
Business Centre, Market Yard, Sligo, Ireland
Tel: 071 91-11975;
e-mail: fmeehan@sligococo.ie



Date	By	Revision

Project N4 Collooney to Castlebaldwin Proposed Road Development

Title Design Overview: Geometrics Mainline
Ch. 10,950m to Ch. 12,810m

Scales (@A3) H 1:5,000 V 1:500	Date December 2013	Job No. SO/01/150
Design FM	Drawn BR	Checked FM
		Approved AS

Figure No.: Fig. 4.2.7
Sheet 7 of 8